

### GT-TC093X-HXXX-LX

G-SWITCH

**Operating Force**  
 A=160gf  
 B=250gf  
 C=100gf

**Switch Height (mm)**  
 H025=2.5mm  
 H031=3.1mm  
 H035=3.5mm  
 H050=5.0mm

**Switch lifetime (Force)**  
 L1=100,000 Cycles  
 L3=300,000 Cycles

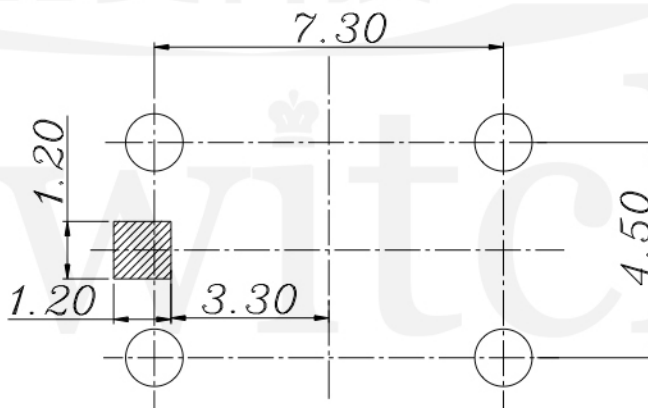
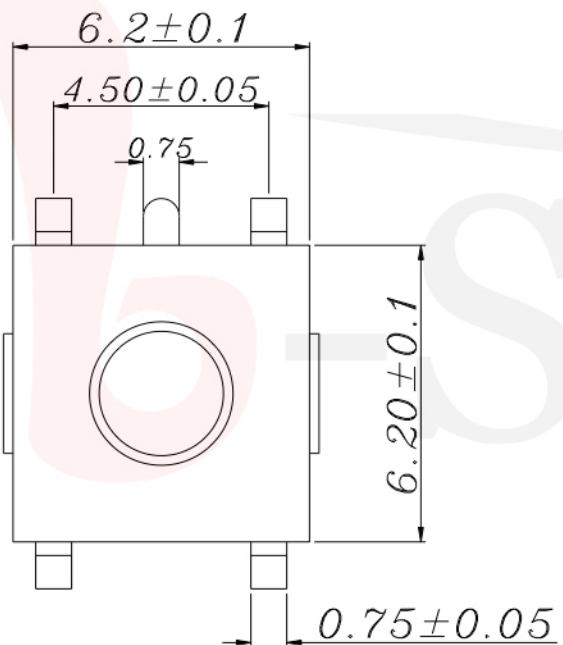

### P.C.B LAND DIMENSION

#### G-Switch Specification:

Operating temperature range : -30°C to +85°C  
 Rating : 50mA, 12V DC  
 Insulation resistance : 100MΩ min. 100V DC  
 Dielectric strength : 250V AC for 1 min  
 Contact resistance : 100mΩ max.  
 Travel: 0.25±0.1mm

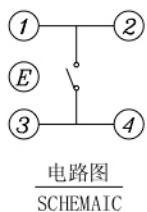

	G-Switch Electronic (HongKong) CO.,Ltd.		
	Unless otherwise specified, Tolerance: X.           ±0.30 X.x         ±0.20 X.xx        ±0.15 X.xxx       ±0.10 Angles      ±3°	DESIGN FengFengChen CHECKED            DATE APPROVED           DATE	DATE 2019.05.29 Molde code: <b>GT-TC093X-HXXX-LX</b>
<a href="http://www.dg-switch.com">http://www.dg-switch.com</a> TEL:0769-82388879		REV.: X1 SCALE: 4:1 SIZE: A4	UNIT: mm SHEET: 1/1

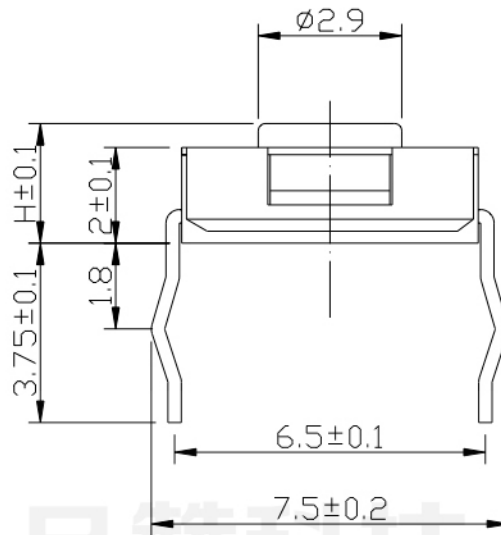
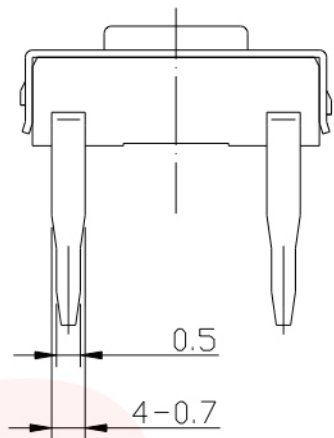

### GT-TCA93X-HXXX-LX

G-SWITCH

**Operating Force**  
 A=160gf  
 B=250gf  
 C=100gf

**Switch Height (mm)**  
 H025=2.5mm  
 H031=3.1mm  
 H035=3.5mm  
 H050=5.0mm

**Switch lifetime (Force)**  
 L1=100,000 Cycles  
 L3=300,000 Cycles

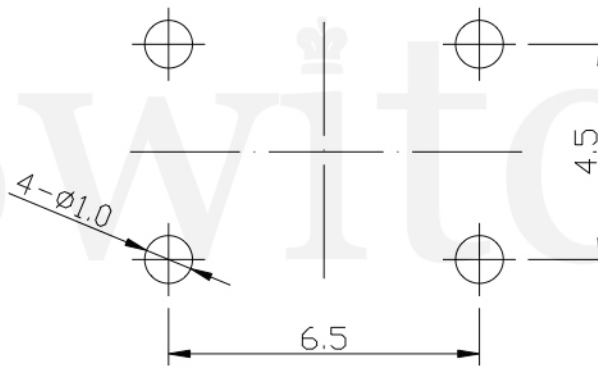
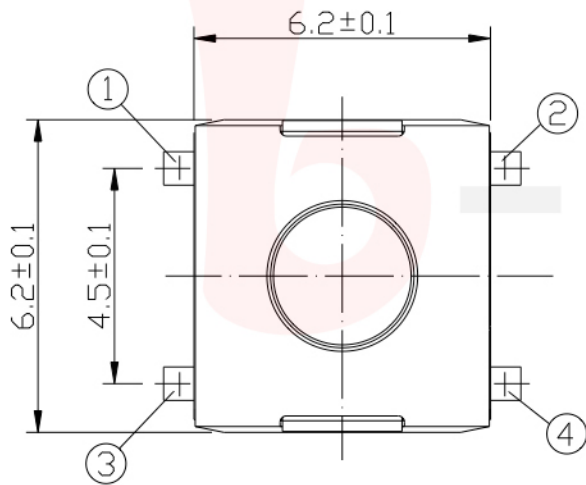

### P.C.B LAND DIMENSION

**G-Switch Specification:**

Operating temperature range : -30°Cto+85°C  
 Rating : 50mA.12V DC  
 Insulation resistance: : 100MΩ min.100V DC  
 Dielectric strength : 250V AC for 1 min  
 Contact resistance: : 100m Ω max.  
 Travel:0.25±0.1mm

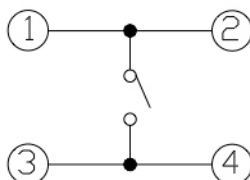

### CIRCUIT DIAGRAM



	<b>G-Switch Electronic (HongKong) CO.,Ltd.</b>		
	DESIGN FengFengChen	DATE 2019.05.29	Molde code: <b>GT-TCA93X-HXXX-LX</b>
	CHECKED	DATE	
	APPROVED	DATE	REV.: X1 SCALE: 4:1 UNIT: mm SIZE: A4 SHEET: 1/1
Unless otherwise specified, Tolerance: X.           ±0.30 X.x         ±0.20 X.xx       ±0.15 X.xxx      ±0.10 Angles     ±3°		<a href="http://www.dg-switch.com">http://www.dg-switch.com</a> TEL:0769-82388879	