

**GT-TC030X-HXXX-LXA**

**G-SWITCH**

**Operating Force**  
 A=160gf  
 B=250gf  
 C=100gf  
 D=400gf

**Switch Height (mm)**  
 H018=1.8mm  
 H020=2.0mm  
 H022=2.2mm  
 H025=2.5mm  
 H030=3.0mm

**Switch lifetime (Force)**  
 L1=100,000 Cycles

A=Base With Pilot  
 N=Non Pilot

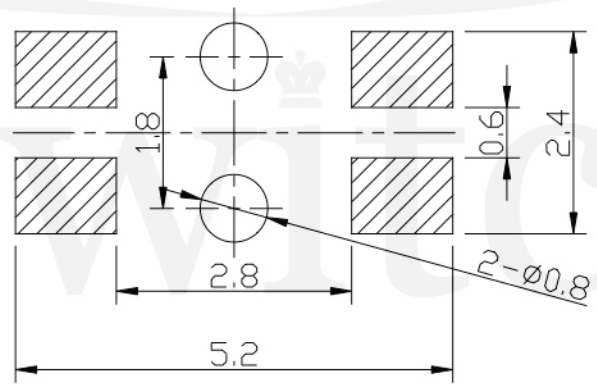
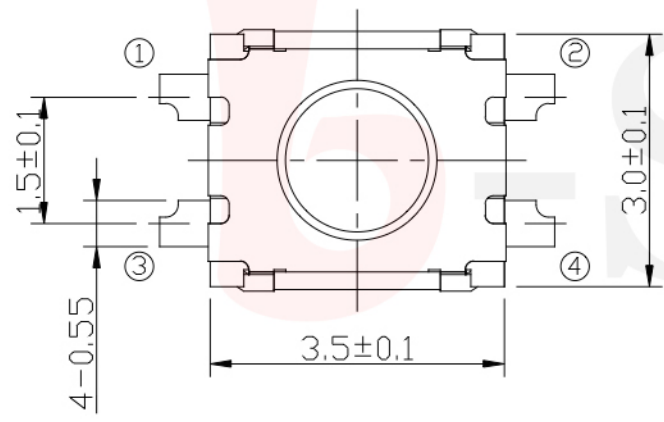

**P.C.B LAND DIMENSION**

**G-Switch Specification:**

Operating temperature range : -30°Cto+85°C  
 Rating : 50mA.12V DC  
 Insulation resistance : 100MΩ min.100V DC  
 Dielectric strength : 250V AC for 1 min  
 Contact resistance : 100m Ω max.  
 Travel:0.15±0.05mm

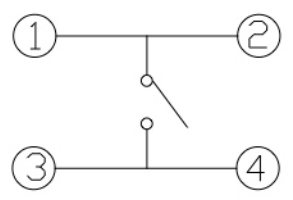

**CIRCUIT DIAGRAM**



	<b>G-Switch Electronic (HongKong) CO.,Ltd.</b>		
	DESIGN FengFengChen CHECKED APPROVED <a href="http://www.dg-switch.com">http://www.dg-switch.com</a> TEL:0769-82388879	DATE 2019.05.29 DATE DATE	Molde code: <b>GT-TC030X-HXXX-LXA</b> REV.: X1 SCALE: 4:1 UNIT: mm SIZE: A4 SHEET: 1/1
Unless otherwise specified, Tolerance: X. ±0.30 X.x ±0.20 X.xx ±0.15 X.xxx ±0.10 Angles ±3°			

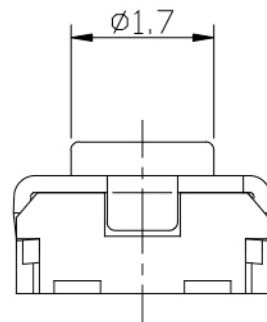
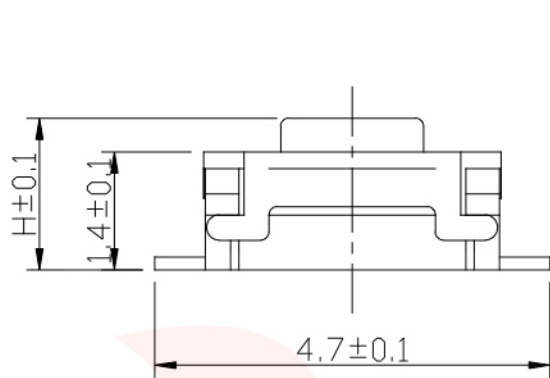

GT-TC030X-HXXX-LXN

G-SWITCH

Operating Force

- A=160gf
- B=250gf
- C=100gf
- D=400gf

Switch Height (mm)

- H018=1.8mm
- H020=2.0mm
- H022=2.2mm
- H025=2.5mm
- H030=3.0mm

Switch lifetime (Force)

L1=100,000 Cycles

A=Base With Pilot  
N=Non Pilot

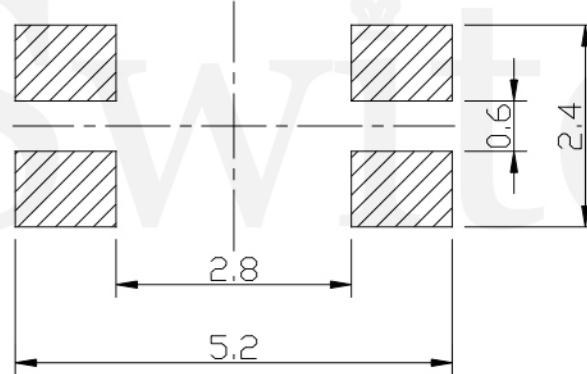
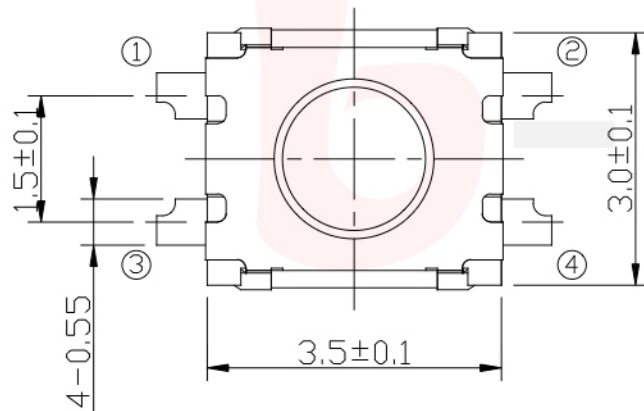

P.C.B LAND DIMENSION

**G-Switch Specification:**

Operating temperature range : -30°Cto+85°C  
 Rating : 50mA.12V DC  
 Insulation resistance : 100MΩ min.100V DC  
 Dielectric strength : 250V AC for 1 min  
 Contact resistance : 100m Ω max.  
 Travel:0.15±0.05mm

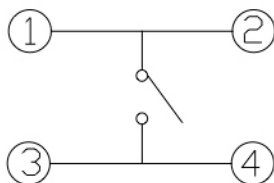

CIRCUIT DIAGRAM



**G-Switch Electronic (HongKong) CO.,Ltd.**

Unless otherwise specified, Tolerance:  
 X. ±0.30  
 X.x ±0.20  
 X.xx ±0.15  
 X.xxx ±0.10  
 Angles ±3°

DESIGN FengFengChen DATE 2019.05.29  
 CHECKED DATE  
 APPROVED DATE  
<http://www.dg-switch.com>  
 TEL:0769-82388879

Molde code:  
**GT-TC030X-HXXX-LXN**  
 REV.: X1 SCALE: 4:1 UNIT: mm  
 SIZE: A4 SHEET: 1/1