

GT-F0518 S R 25 -XX X XX 01

G-Switch
Series No
Termpoint S-SMT
Angle R-90°
Terminal Plating 01-G/F
Housing Colour S-Nature
Pin Q' PY 04~80
Height 25-2.55mm

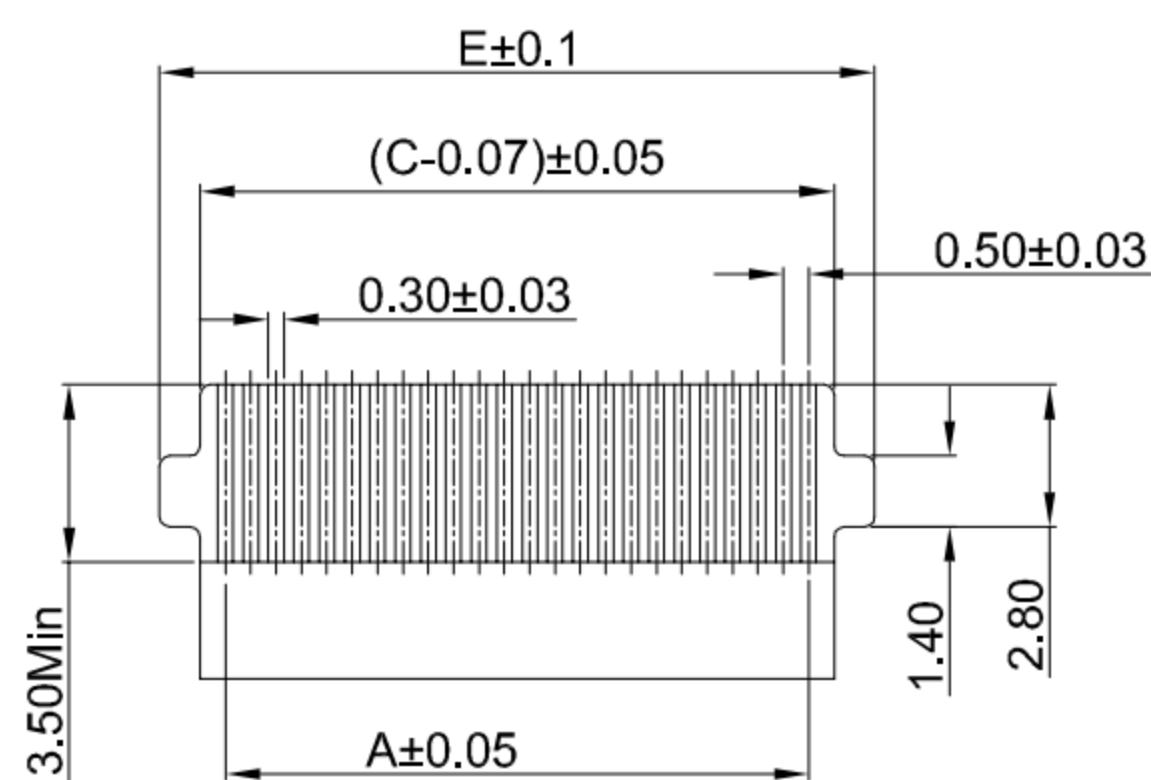

APPLICABLE FPC

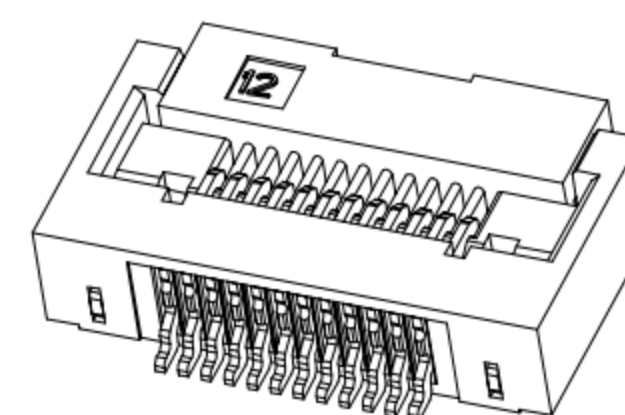
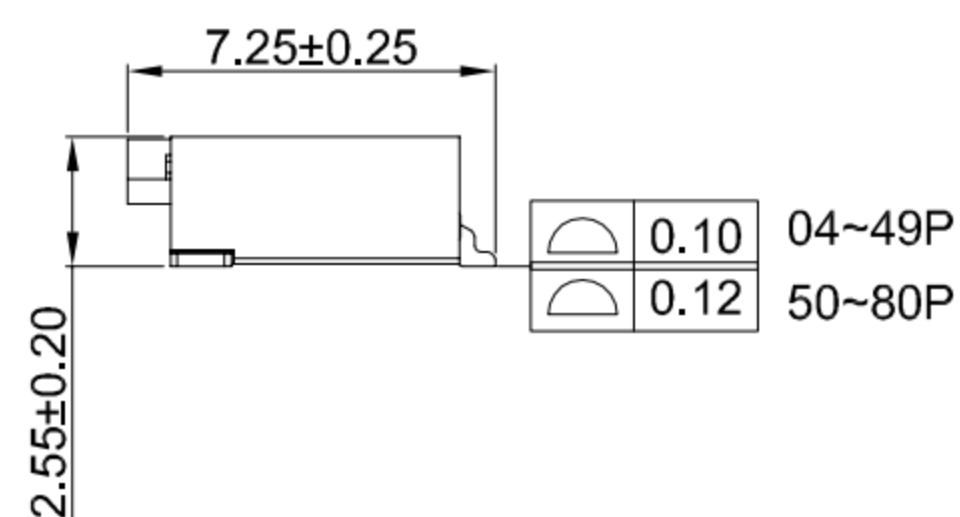
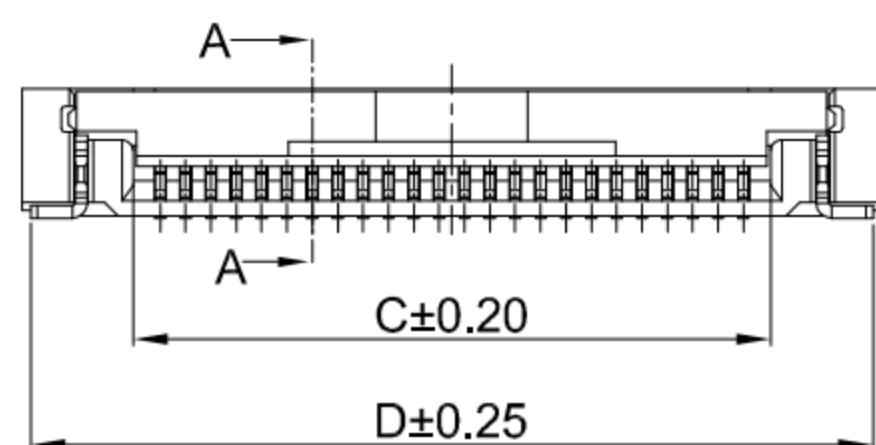
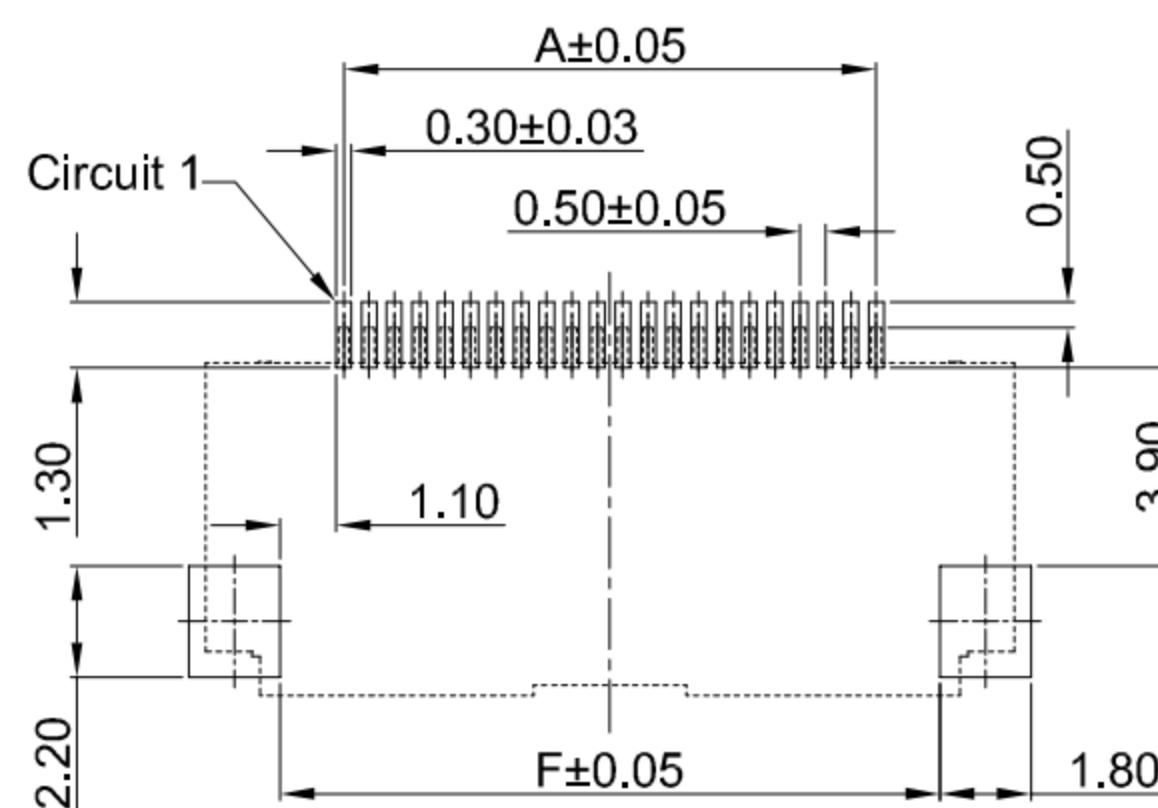
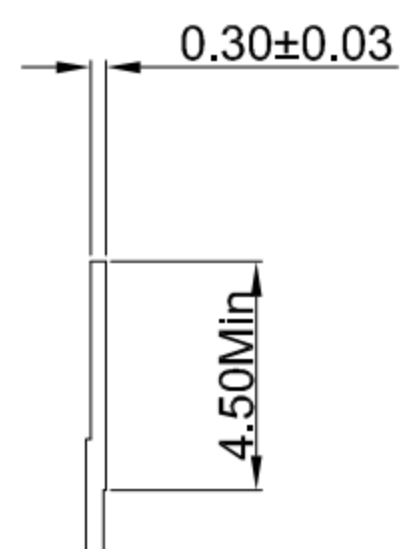

RECOMMENDED PCB LAYOUT
 TOLERANCE: ±0.05

G-Switch Specification:

1. Current rated: 0.5A AC/DC
2. Voltage rating: 50V AC/DC
3. Withstanding voltage: 150V AC
4. Contact resistance: 50mΩ max.
5. Insulation resistance: 500MΩ min
6. Durability cycle: 20Cycles
7. Removal force: 0.03kgf/Pin min
8. Operating temperature range: -25°C ~ +85°C

4	SOLDER TABS	BRASS	MATTE Tin
3	CONTACT	PHOSPHOR BRONZE	Gold-Flash On Contact Area
2	COVER	LCP,94V-0	BLACK
1	HOUSING	LCP,94V-0	NATURE
NO.	PART NAME	MATERIAL	REMARK



SCALE: 1:1 UNIT: mm
 SIZE: A4

Unless otherwise
 General Tolerance:
 X ±0.40
 X.x ±0.30
 X.xx ±0.20
 X* ±5°
 X.x° ±3°

Title: FPC 0.50mm Pitch 90° H2.55mm SMT Type With Lock Connector

Molde Code: GT-F0518SR25-XXXXX01

DRAWN	CHECKED	APPROVED	DATE
Hu	Chen	Chen	2022.12.28



REV: A0 SHEET: 1/2

Ordering Information:

Circuit	Dimensions(mm)						Circuit	Dimensions(mm)					
	A	B	C	D	E	F		A	B	C	D	E	F
05	2.00	7.45	3.07	7.10	4.60	4.50	43	21.00	26.45	22.07	26.10	23.60	23.50
06	2.50	7.95	3.57	7.60	5.10	5.00	44	21.50	26.95	22.57	26.60	24.10	24.00
07	3.50	8.45	4.07	8.10	5.60	5.50	45	22.00	27.45	23.07	27.10	24.60	24.50
08	3.50	8.95	4.57	8.60	6.10	6.00	46	22.50	27.95	23.57	27.60	25.10	25.00
09	4.00	9.45	5.07	9.10	6.60	6.50	47	23.00	28.45	24.07	28.10	25.60	25.50
10	4.50	9.95	5.57	9.60	7.10	7.00	48	23.50	28.95	24.57	28.60	26.10	26.00
11	5.00	10.45	6.07	10.10	7.60	7.50	49	24.00	29.45	25.07	29.10	26.60	26.50
12	5.50	10.95	6.57	10.60	8.10	8.00	50	24.50	29.95	25.57	29.60	27.10	27.00
13	6.00	11.45	7.07	11.10	8.60	8.50	51	25.00	30.45	26.07	30.10	27.60	27.50
14	6.50	11.95	7.57	11.60	9.10	9.00	52	25.50	30.95	26.57	30.60	28.10	28.00
15	7.00	12.45	8.07	12.10	9.60	9.50	53	26.00	31.45	27.07	31.10	28.60	28.50
16	7.50	12.95	8.57	12.60	10.10	10.00	54	26.50	31.95	27.57	31.60	29.10	29.00
17	8.00	13.45	9.07	13.10	10.60	10.50	55	27.00	32.45	28.07	32.10	29.60	29.50
18	8.50	13.95	9.57	13.60	11.10	11.00	56	27.50	32.95	28.57	32.60	30.10	30.00
19	9.00	14.45	10.07	14.10	11.60	11.50	57	28.00	33.45	29.07	33.10	30.60	30.50
20	9.50	14.95	10.57	14.60	12.10	12.00	58	28.50	33.95	29.57	33.60	31.10	31.00
21	10.00	15.45	11.07	15.10	12.60	12.50	59	29.00	34.45	30.07	34.10	31.60	31.50
22	10.50	15.95	11.57	15.60	13.10	13.00	60	29.50	34.95	30.57	34.60	32.10	32.00
23	11.00	16.45	12.07	16.10	13.60	13.50	61	30.00	35.45	31.07	35.10	32.60	32.50
24	11.50	16.95	12.57	16.60	14.10	14.00	62	30.50	35.95	31.57	35.60	33.10	33.00
25	12.00	17.45	13.07	17.10	14.60	14.50	63	31.00	36.45	32.07	36.10	33.60	34.50
26	12.50	17.95	13.57	17.60	15.10	15.00	64	31.50	36.95	32.57	36.60	34.10	34.00
27	13.00	18.45	14.07	18.10	15.60	15.50	65	32.00	37.45	33.07	37.10	34.60	34.50
28	13.50	18.95	14.57	18.60	16.10	16.00	66	32.50	37.95	33.57	37.60	35.10	35.00
29	14.00	19.45	15.07	19.10	16.60	16.50	67	33.00	38.45	34.07	38.10	35.60	35.50
30	14.50	19.95	15.57	19.60	17.10	17.00	68	34.50	38.95	34.57	38.60	36.10	36.00
31	15.00	20.45	16.07	20.10	17.60	17.50	69	34.00	39.45	35.07	39.10	36.60	36.50
32	15.50	20.95	16.57	20.60	18.10	18.00	70	34.50	39.95	35.57	39.60	37.10	37.00
33	16.00	21.45	17.07	21.10	18.60	18.50	71	35.00	40.45	36.07	40.10	37.60	37.50
34	16.50	21.95	17.57	21.60	19.10	19.00	72	35.50	40.95	36.57	40.60	38.10	38.00
35	17.00	22.45	18.07	22.10	19.60	19.50	73	36.00	41.45	37.07	41.10	38.60	38.50
36	17.50	22.95	18.57	22.60	20.10	20.00	74	36.50	41.95	37.57	41.60	39.10	39.00
37	18.00	23.45	19.07	23.10	20.60	20.50	75	37.00	42.45	38.07	42.10	39.60	39.50
38	18.50	23.95	19.57	23.60	21.10	21.00	76	37.50	42.95	38.57	42.60	40.10	40.00
39	19.00	24.45	20.07	24.10	21.60	21.50	77	38.00	43.45	39.07	43.10	40.60	40.50
40	19.50	24.95	20.57	24.60	22.10	22.00	78	38.50	43.95	39.57	43.60	41.10	41.00
41	20.00	25.45	21.07	25.10	22.60	22.50	79	39.00	44.45	40.07	44.10	41.60	41.50
42	20.50	25.95	21.57	25.60	23.10	23.00	80	39.50	44.95	40.57	44.60	42.10	42.00



GT-F0518 S R 25 -XX X XX 01

G-Switch

Series No

Termipoint
S-SMT

Angle
R-90°

Terminal Plating
01-G/F

Housing Colour
S-Nature

Pin Q' PY
04~80

Height
25-2.55mm

G-Switch Specification:

- 1.Current rated: 0.5A AC/DC
- 2.Voltage rating: 50V AC/DC
- 3.Withstanding voltage: 150V AC
- 4.Contact resistance: 50mΩ max.
- 5.Insulation resistance: 500MΩ min
- 6.Durability cycle: 20Cycles
- 7.Removal force: 0.03kgf/Pin min
- 8.Operating temperature range: -25°C ~ +85°C

4	SOLDER TABS	BRASS	MATTE Tin
3	CONTACT	PHOSPHOR BRONZE	Gold-Flash On Contact Area
2	COVER	LCP,94V-0	BLACK
1	HOUSING	LCP,94V-0	NATURE
NO.	PART NAME	MATERIAL	REMARK



SCALE: 1:1 UNIT: mm
SIZE: A4

Unless otherwise General Tolerance:

X ±0.40
X.x ±0.30
X.xx ±0.20
X* ±5°
X.x° ±3°

Title: FPC 0.50mm Pitch 90° H2.55mm SMT Type With Lock Connector

Molde Code: GT-F0518SR25-XXXXX01

DRAWN	CHECKED	APPROVED	DATE
Hu	Chen	Chen	2022.12.28



REV: A0 SHEET: 2/2