

A B C D E

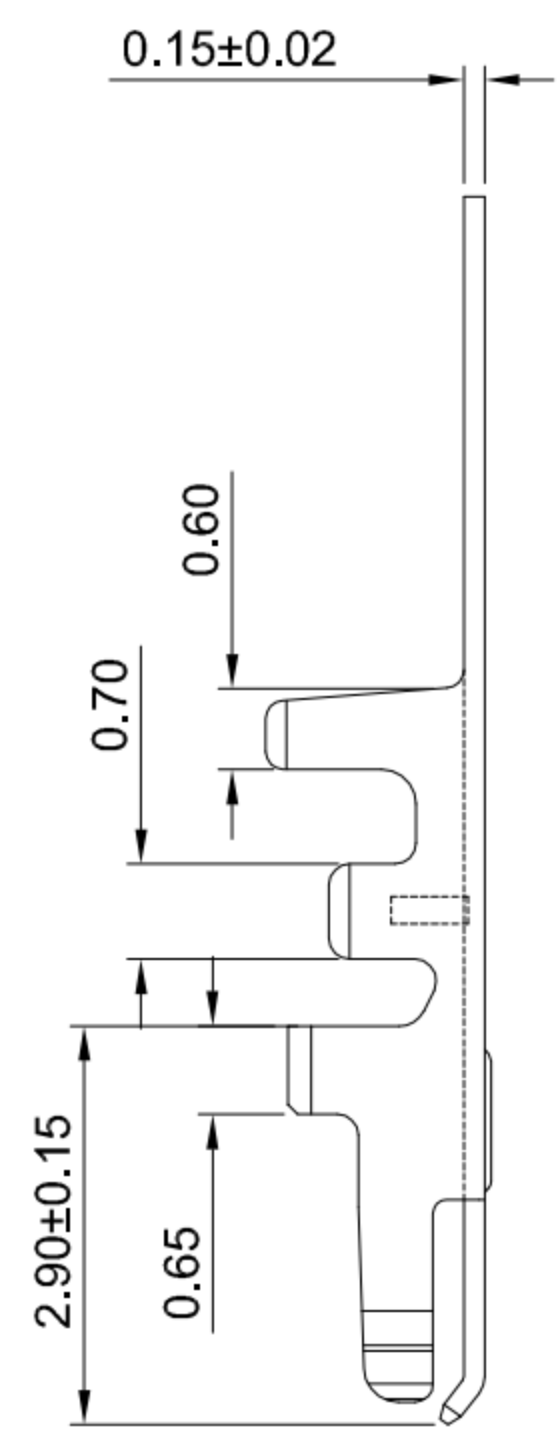
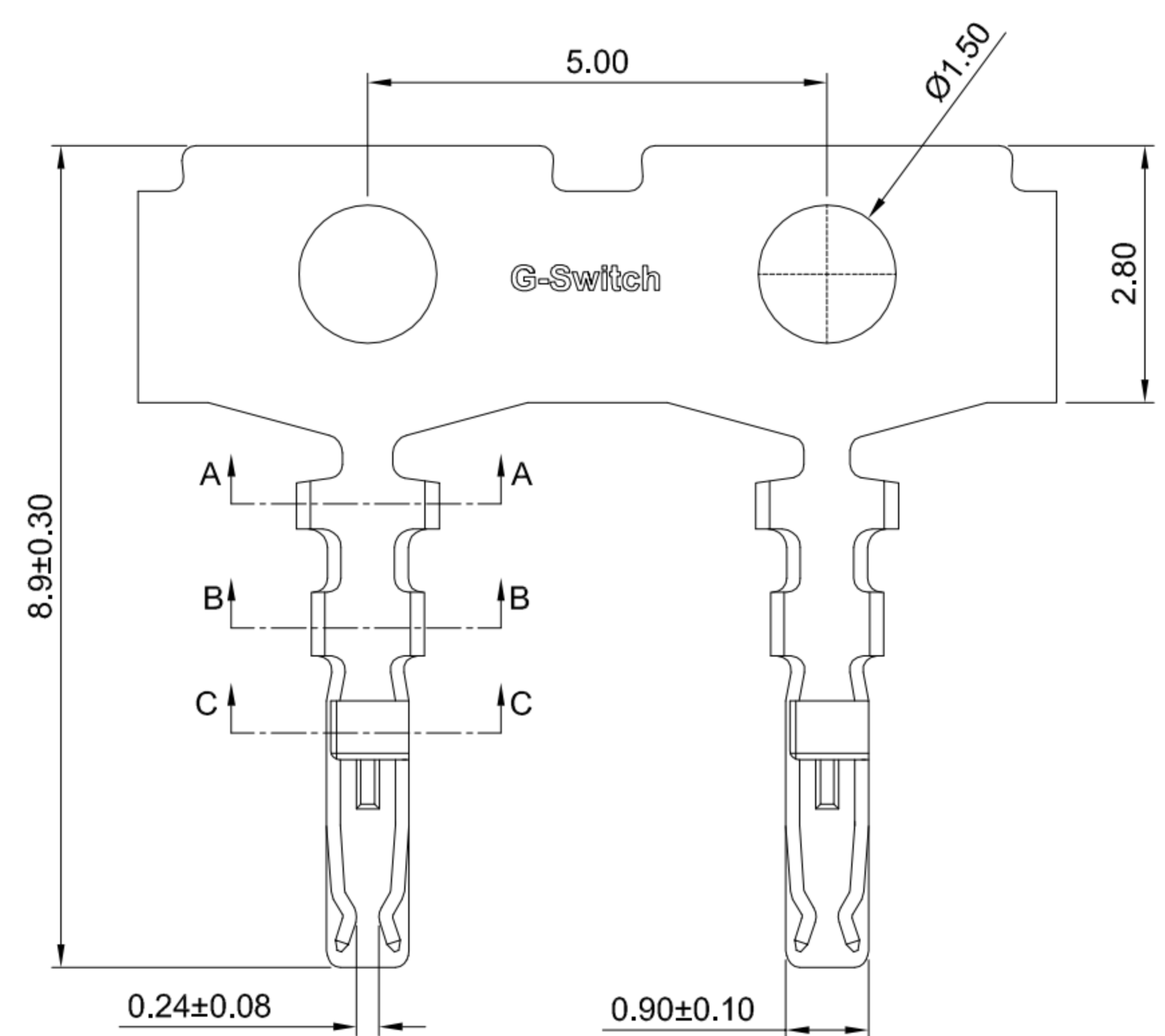

**GT-A1258 T F -X XX 1**

**G-Switch**  
**Series No**  
**Connector**  
 T-Terminal

**Terminal Plating**  
 BT-Bright Tin  
 11-All G/F

**Metal**  
 P-Phosphor Bronze

**F-Female**

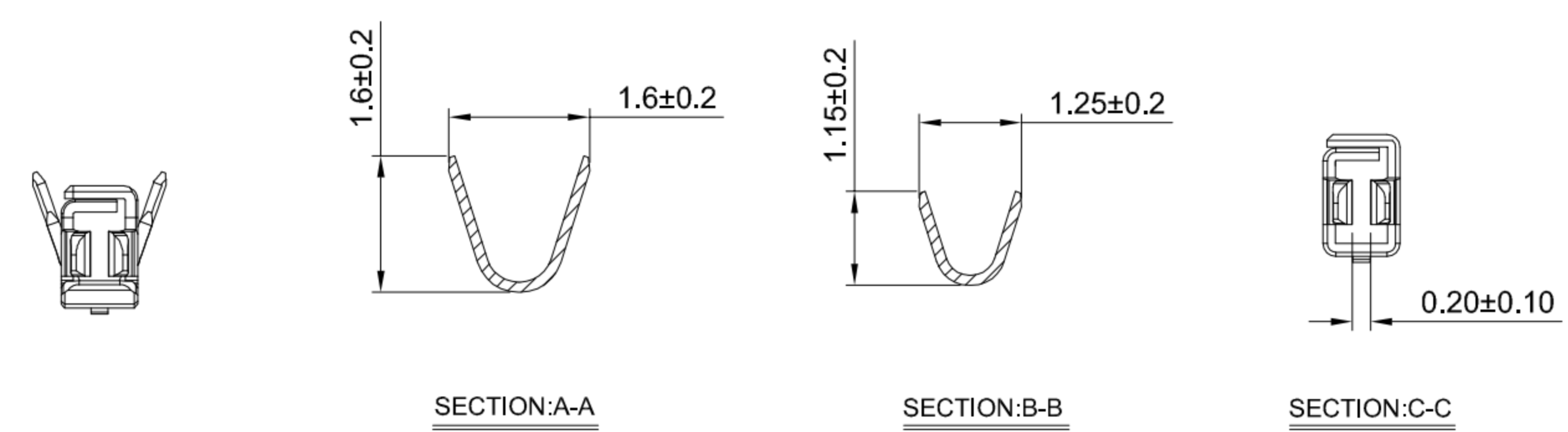

- G-Switch Specification:**
- 1.Current rated: 1.5A AC/DC
  - 2.Voltage rating: 50V AC/DC
  - 3.Withstanding voltage: 500V AC
  - 4.Contact resistance: 20mΩ max.
  - 5.Insulation resistance: 100MΩ min
  - 6.Durability cycle: 50Cycles
  - 7.Removal force: 0.20kgf/Pin min
  - 8.Operating temperature range: -25°C ~ +85°C

GT-A1258TF-PBT1	Phosphor Bronze	Bright Tin	AWG#26~30	1.00mm(Max)	20000
GT-A1258TF-P111	Phosphor Bronze	All G/F	AWG#26~30	1.00mm(Max)	20000
Part NO	Material	Plating	Wire Size	Insulation O.D	Reel/PCS



SCALE: 1:1	UNIT: mm	Title: Terminal 1.25mm Pitch Crimp Style			
SIZE: A4		Molde Code: GT-A1258TF-XXX1			
Unless otherwise General Tolerance:		DRAWN	CHECKED	APPROVED	DATE
X	±0.40	Hu	Chen	Chen	2022.12.28
X.x	±0.30				
X.xx	±0.20				
X*	±5°				
X.x°	±3°				



REV: A0 SHEET: 1/1

A B C D E

1  
2  
3  
4  
5

1  
2  
3  
4  
5