

RECOMMENDED PCB LAYOUT
TOLERANCE:±0.05

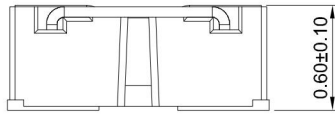

MATING HEIGHT

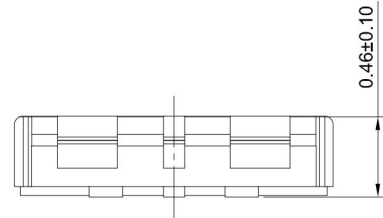
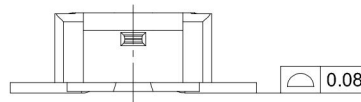
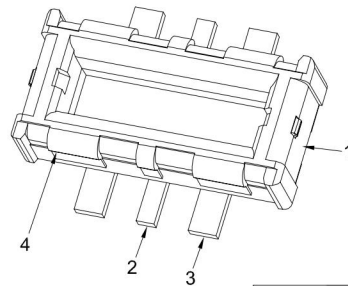

GT-B0353 M S V 05 -XX X XX 01

- G-Switch**
- Series No**
- M-Male**
- Termpoint**
S-SMT
- Angle**
V-180°
- Terminal Plating**
12-Au 2u" Gold all
- Housing Colour**
B-Black
- Pin Q' PY**
6Pin
- Height**
05-0.46mm

G-Switch Specification:

- 1.Current rated: 0.3A AC/DC
- 2.Voltage rating: 30V AC/DC
- 3.Withstanding voltage: 250V AC for 1 min
- 4.Contact resistance: 70mΩ max.Signal pin
Contact resistance: 20mΩ Max. Power pin
- 5.Insulation resistance: 100MΩ min
- 6.Durability cycle: 10 Cycles
- 7.Removal force: 0.015kgf/Pin min
- 8.Operating temperature range: -40°C ~ +85°C

4	SOLDER TABS+HD	2PCS	PHOSPHOR BRONZ	Au2u" ON SOLDERED AREA
3	POWER PIN	S1-S4	PHOSPHOR BRONZ	Au2u" ON CONTACT AREA
2	SIGNAL PIN	PIN1 - PIN2	PHOSPHOR BRONZ	Au2u" ON CONTACT AREA
1	HOUSING	1PCS	LCP,94V-0	BLACK
NO.	PART NAME	NUMBER	MATERIAL	REMARK

SCALE: 1:1 UNIT: mm
SIZE: A4

Unless otherwise
General Tolerance:

X	±0.30
X.x	±0.20
X.xx	±0.15
X.xxx	±0.10
X°	±4°

Title: BTB 0.35mm Pitch 180° H0.50mm 2+4PIN
SMT Type Male Connector

Molde Code: GT-B0353MSV05-02B1201

DRAWN	CHECKED	APPROVED	DATE
Hu	Chen	Chen	2022.12.28



REV: A0 SHEET: 1/1