

A

B

C

D

E

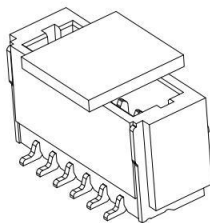
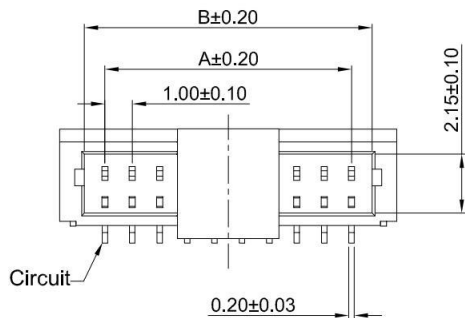
**G-Switch Specification:**

1. Current rated: 1.0A AC/DC
2. Voltage rating: 50V AC/DC
3. Withstanding voltage: 500V AC
4. Contact resistance: 20mΩ max.
5. Insulation resistance: 100MΩ min
6. Durability cycle: 50Cycles
7. Removal force: 0.50kgf/Pin min
8. Operating temperature range: -25°C ~ +85°C

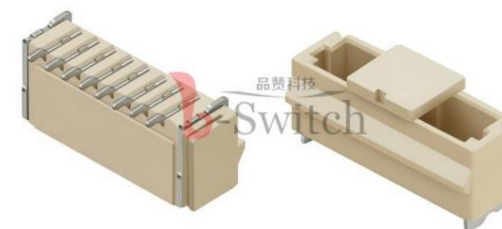

1

1

2

2

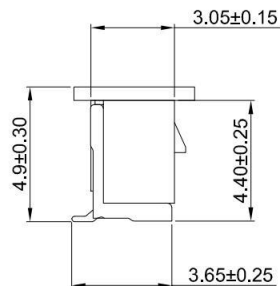
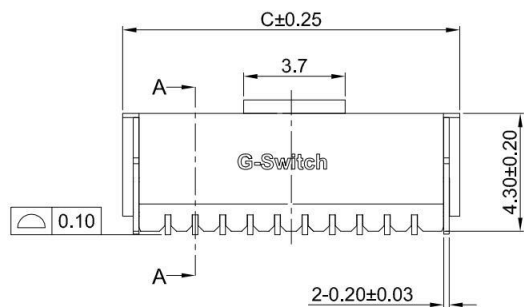

GT-A1002 W V S 1-1 XX X XX 01

G-Switch**Series No****Connector****Angle**

V-180°

Termipoint

S-SMT

Terminal Plating
BT-Bright Tin
11-All G/F**Housing Colour**
S-Nature**Pin Q' PY**
02~20**Row NO**
1-Single row**Type**
1-Type 1

3

3

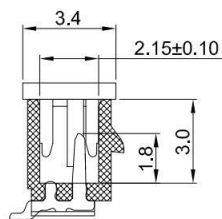
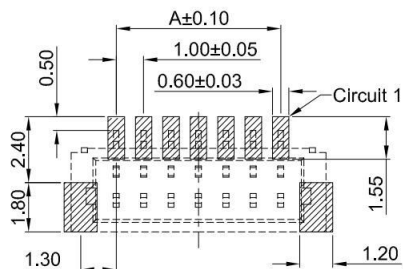

SECTION:A-A

Ordering Information:

Circuit	Dimensions(mm)			Circuit	Dimensions(mm)		
	A	B	C		A	B	C
02	---	2.50	4.20	12	11.00	12.50	14.20
03	2.00	3.50	5.20	13	12.00	13.50	15.20
04	3.00	4.50	6.20	14	13.00	14.50	16.20
05	4.00	5.50	7.20	15	14.00	15.50	17.20
06	5.00	6.50	8.20	16	15.00	16.50	18.20
07	6.00	7.50	9.20	17	16.00	17.50	19.20
08	7.00	8.50	10.20	18	17.00	18.50	20.20
09	8.00	9.50	11.20	19	18.00	19.50	21.20
10	9.00	10.50	12.20	20	19.00	20.50	22.20
11	10.00	11.50	13.20	---	---	---	---

4

4

NO.	PART NAME	MATERIAL	REMARK
4	SOLDER TABS	BRASS	BRIGHT Tin
3	CONTACT	BRASS	BRIGHT Tin / All G/F
2	CAP	LCP,94V-0	NATURE
1	HOUSING	LCP,94V-0	NATURE

A

B

C

D

E

SCALE: 1:1 UNIT: mm

SIZE: A4

Unless otherwise
General Tolerance:

X	±0.40
X.x	±0.30
X.xx	±0.20
X°	±5°
X.x°	±3°

Title: Wafer 1.00mm Pitch 180° SH SMT
With Lock Type Connector

Molde Code: GT-A1002WVS1-1XXXXX01

DRAWN	CHECKED	APPROVED	DATE
Hu	Hu	Chen	2021.10.20

REV: A0

SHEET: 1/1

5

5

