

SECTION:A-A

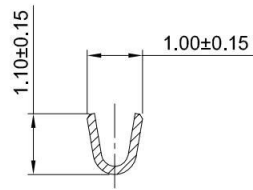

SECTION:B-B

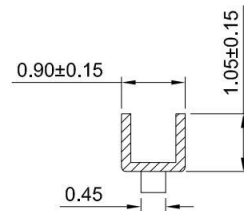

SECTION:C-C



GT-A1251 T M -X XX 1

G-Switch

Series No

Connector
T-Terminal

Terminal Plating
BT-Bright Tin
11-All G/F

Metal
P-Phosphor Bronze

M-Male

G-Switch Specification:

- 1.Current rated: 1.0A AC/DC
- 2.Voltage rating: 125V AC/DC
- 3.Withstanding voltage: 250V AC
- 4.Contact resistance: 20mΩ max.
- 5.Insulation resistance: 100MQ min
- 6.Durability cycle: 50Cycles
- 7.Removal force: 0.50kgf/Pin min
- 8.Operating temperature range: -25°C ~ +85°C

| GT-A1251TM-PBT1 | Phosphor Bronze | Bright Tin | AWG#28~32 | 1.00mm(Max) | 20000 |
|-----------------|-----------------|------------|-----------|----------------|----------|
| Part NO | Material | Plating | Wire Size | Insulation O.D | Reel/PCS |



SCALE: 1:1 UNIT: mm
SIZE: A4

Unless otherwise
General Tolerance:
X ±0.40
X.x ±0.30
X.xx ±0.20
X° ±5°
X.x° ±3°

Title: Terminal 1.25mm Pitch Crimp Style Male

Molde Code: GT-A1251TM-XXX1

| DRAWN | CHECKED | APPROVED | DATE |
|-------|---------|----------|------------|
| Hu | Chen | Chen | 2022.12.28 |



REV: A0 SHEET: 1/1