

GT-A1254 T F -X XX 1

**G-Switch**  
**Series No**  
**Connector**  
**Terminal Plating**  
 BT-Bright Tin  
 11-All G/F  
**Metal**  
 P-Phosphor Bronze  
**F-Female**  
 T-Terminal

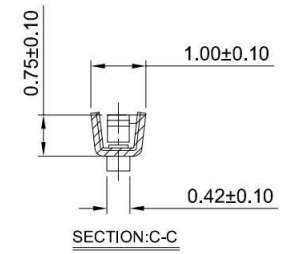
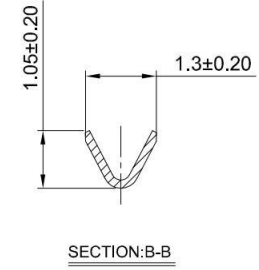
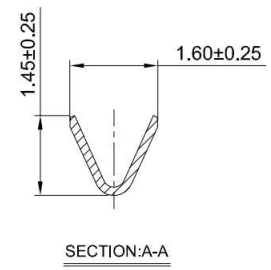

- G-Switch Specification:**
- 1.Current rated: 1.0A AC/DC
  - 2.Voltage rating: 125V AC/DC
  - 3.Withstanding voltage: 500V AC
  - 4.Contact resistance: 20mΩ max.
  - 5.Insulation resistance: 100MΩ min
  - 6.Durability cycle: 25Cycles
  - 7.Removal force: 0.80kgf/Pin min
  - 8.Operating temperature range: -25°C ~ +85°C

GT-A1254TF-PBT1	Phosphor Bronze	Bright Tin	AWG#28~32	1.00mm(Max)	25000
GT-A1254TF-P111	Phosphor Bronze	All G/F	AWG#28~32	1.00mm(Max)	25000
Part NO	Material	Plating	Wire Size	Insulation O.D	Reel/PCS



SCALE: 1:1 UNIT: mm  
 SIZE: A4  
 Unless otherwise General Tolerance:  
 X ±0.40  
 X.x ±0.30  
 X.xx ±0.20  
 X° ±5°  
 X.x° ±3°

Title: Terminal 1.25mm Pitch Crimp Style			
Molde Code: GT-A1254TF-XXX1			
DRAWN	CHECKED	APPROVED	DATE
Hu	Chen	Chen	2022.12.28



REV: A0 SHEET: 1/1