

A

B

C

D

E

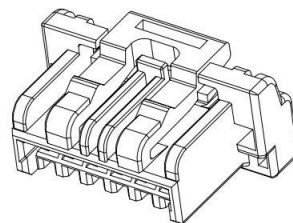
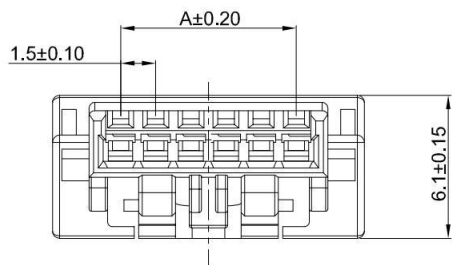

GT-A1515 H M -1 XX X 01

G-Switch

Series No

Connector

H-Housing

M-Male

Housing Colour  
W-WhitePin Q' PY  
02~15Row NO  
1-Single Row**G-Switch Specification:**

1. Current rated: 2.0A AC/DC
2. Voltage rating: 100V AC/DC
3. Withstanding voltage: 500V AC
4. Contact resistance: 20mΩ max.
5. Insulation resistance: 500MΩ min
6. Durability cycle: 50Cycles
7. Removal force: 0.3kgf/Pin min
8. Operating temperature range: -40°C ~ +125°C

**Ordering Information:**

| Circuit | Dimensions(mm) |       |       | Circuit | Dimensions(mm) |       |       |
|---------|----------------|-------|-------|---------|----------------|-------|-------|
|         | A              | B     | C     |         | A              | B     | C     |
| 02      | ---            | 4.20  | 7.30  | 09      | 12.00          | 14.70 | 17.80 |
| 03      | 3.00           | 5.70  | 8.80  | 10      | 13.50          | 16.20 | 19.30 |
| 04      | 4.50           | 7.20  | 10.30 | 11      | 15.00          | 17.70 | 20.80 |
| 05      | 6.00           | 8.70  | 11.80 | 12      | 16.50          | 19.20 | 22.30 |
| 06      | 7.50           | 10.20 | 13.30 | 13      | 18.00          | 20.70 | 23.80 |
| 07      | 9.00           | 11.70 | 14.80 | 14      | 19.50          | 22.20 | 25.30 |
| 08      | 10.50          | 13.20 | 16.30 | 15      | 21.00          | 23.70 | 26.80 |

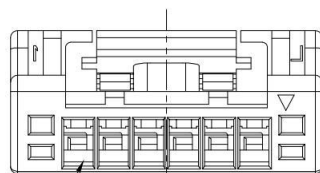
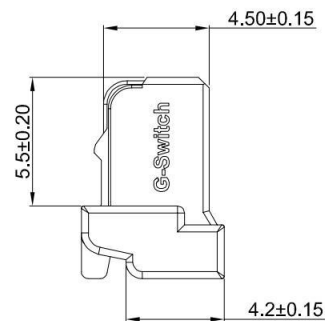
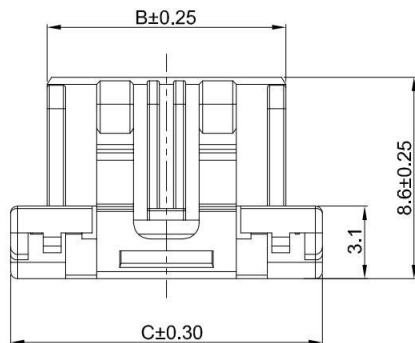

Circuit 1

SCALE: 1:1 UNIT: mm

SIZE: A4

Title: Housing 1.50mm Pitch MX Single Row Male

Molde Code: GT-A1515HM-1XXX01

| DRAWN | CHECKED | APPROVED | DATE       |
|-------|---------|----------|------------|
| Hu    | Hu      | Chen     | 2021.10.20 |

REV: A0

SHEET: 1/2

| NO. | PART NAME | MATERIAL  | REMARK |
|-----|-----------|-----------|--------|
| 1   | HOUSING   | PBT,94V-0 | WHITE  |



A

B

C

D

E

A

B

C

D

E

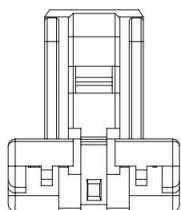

2-3Pin Lock

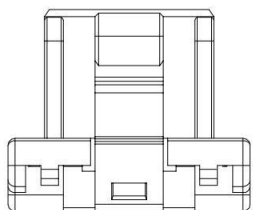
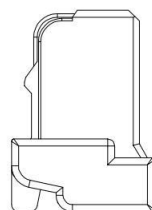

4-5Pin Lock

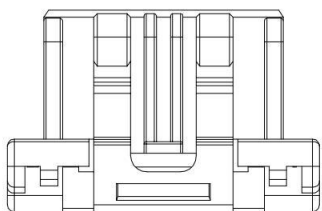
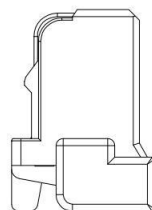

6-15Pin Lock

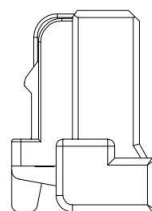

GT-A1515 H M -1 XX X 01

G-Switch

Series No

Connector

H-Housing

M-Male

Housing Colour  
W-White

Pin Q' PY

02~15

Row NO

1-Single Row

**G-Switch Specification:**

- 1.Current rated: 2.0A AC/DC
- 2.Voltage rating: 100V AC/DC
- 3.Withstanding voltage: 500V AC
- 4.Contact resistance: 20mΩ max.
- 5.Insulation resistance: 500MΩ min
- 6.Durability cycle: 50Cycles
- 7.Removal force: 0.3kgf/Pin min
- 8.Operating temperature range: -40°C ~ +125°C

**Ordering Information:**

| Circuit | Dimensions(mm) |       |       | Circuit | Dimensions(mm) |       |       |
|---------|----------------|-------|-------|---------|----------------|-------|-------|
|         | A              | B     | C     |         | A              | B     | C     |
| 02      | ---            | 4.20  | 7.30  | 09      | 12.00          | 14.70 | 17.80 |
| 03      | 3.00           | 5.70  | 8.80  | 10      | 13.50          | 16.20 | 19.30 |
| 04      | 4.50           | 7.20  | 10.30 | 11      | 15.00          | 17.70 | 20.80 |
| 05      | 6.00           | 8.70  | 11.80 | 12      | 16.50          | 19.20 | 22.30 |
| 06      | 7.50           | 10.20 | 13.30 | 13      | 18.00          | 20.70 | 23.80 |
| 07      | 9.00           | 11.70 | 14.80 | 14      | 19.50          | 22.20 | 25.30 |
| 08      | 10.50          | 13.20 | 16.30 | 15      | 21.00          | 23.70 | 26.80 |

SCALE: 1:1 UNIT: mm

SIZE: A4

Unless otherwise  
General Tolerance:

X ±0.40  
X.x ±0.30  
X.xx ±0.20  
X° ±5°  
X.x° ±3°

Title: Housing 1.50mm Pitch MX Single Row Male

Molde Code: GT-A1515HM-1XXX01

| DRAWN | CHECKED | APPROVED | DATE       |
|-------|---------|----------|------------|
| Hu    | Hu      | Chen     | 2021.10.20 |

品赞科技®  
**b-Switch**  
www.dg-switch.com

REV: A0

SHEET: 2/2

| NO. | PART NAME | MATERIAL  | REMARK |
|-----|-----------|-----------|--------|
| 1   | HOUSING   | PBT,94V-0 | WHITE  |



A

B

C

D

E