

A

B

C

D

E

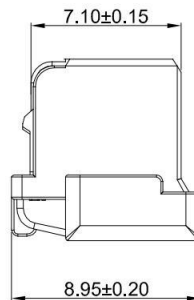
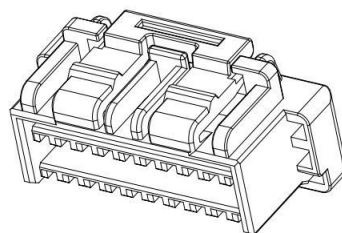
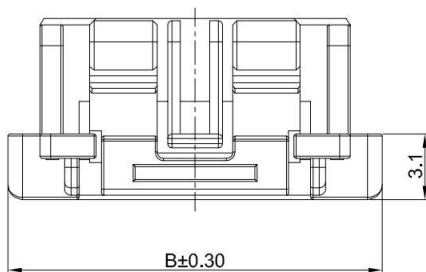
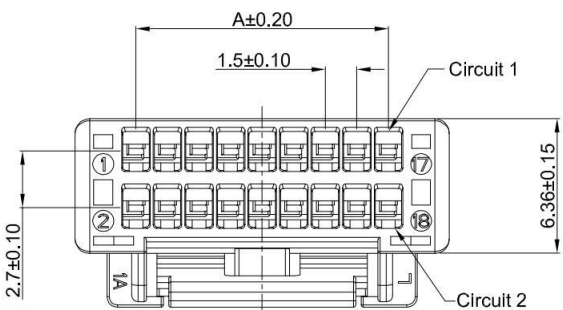
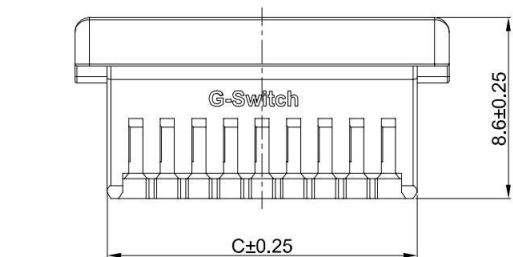

GT-A1515 H M -2 XX X 01

G-Switch

Series No

Connector
H-Housing

M-Male

Housing Colour
W-WhitePin Q' PY
08~26Row NO
2-Dual Rows**G-Switch Specification:**

- 1.Current rated: 2.0A AC/DC
- 2.Voltage rating: 100V AC/DC
- 3.Withstanding voltage: 500V AC
- 4.Contact resistance: 20mΩ max.
- 5.Insulation resistance: 500MΩ min
- 6.Durability cycle: 50Cycles
- 7.Removal force: 0.3kgf/Pin min
- 8.Operating temperature range: -40°C ~ +125°C

Ordering Information:

Circuit	Dimensions(mm)			Circuit	Dimensions(mm)		
	A	B	C		A	B	C
08	4.50	10.30	7.25	18	12.00	17.80	14.75
10	6.00	11.80	8.75	20	13.50	19.30	16.25
12	7.50	13.30	10.25	22	15.00	20.80	17.75
14	9.00	14.80	11.75	24	16.50	22.30	19.25
16	10.50	16.30	13.25	26	18.00	23.80	20.75

SCALE: 1:1 UNIT: mm

SIZE: A4

Unless otherwise
General Tolerance:
X ±0.40
X.x ±0.30
X.xx ±0.20
X° ±5°
X.x° ±3°

Title: Housing 1.50mm Pitch MX Dual Rows Male

Molde Code: GT-A1515HM-2XXX01

DRAWN	CHECKED	APPROVED	DATE
Hu	Hu	Chen	2021.10.20

品赞科技®
b-Switch
www.dg-switch.com

REV: A0

SHEET: 1/2

1	HOUSING	PBT,94V-0	WHITE
NO.	PART NAME	MATERIAL	REMARK



A

B

C

D

E

1

1



2

2

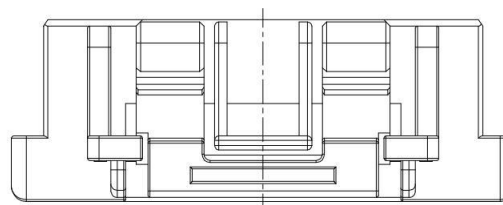
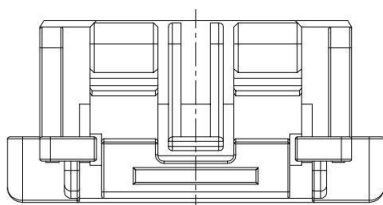
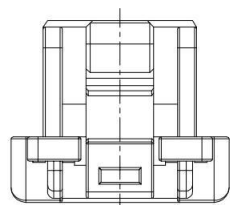

GT-A1515 H M -2 XX X 01

G-Switch

Series No

Connector
H-Housing

M-Male

Housing Colour
W-WhitePin Q' PY
08~26Row NO
2-Dual Rows

3

3

G-Switch Specification:

- 1.Current rated: 2.0A AC/DC
- 2.Voltage rating: 100V AC/DC
- 3.Withstanding voltage: 500V AC
- 4.Contact resistance: 20mΩ max.
- 5.Insulation resistance: 500MΩ min
- 6.Durability cycle: 50Cycles
- 7.Removal force: 0.3kgf/Pin min
- 8.Operating temperature range: -40°C ~ +125°C

4

4

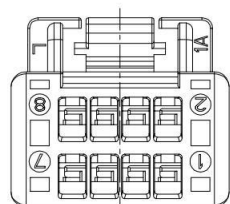

08-10Pin

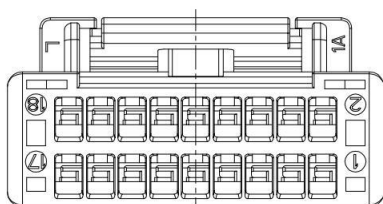

12-18Pin

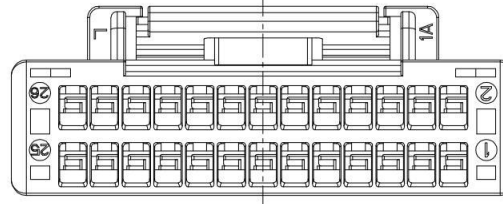

20-26Pin

Ordering Information:

Circuit	Dimensions(mm)			Circuit	Dimensions(mm)		
	A	B	C		A	B	C
08	4.50	10.30	7.25	18	12.00	17.80	14.75
10	6.00	11.80	8.75	20	13.50	19.30	16.25
12	7.50	13.30	10.25	22	15.00	20.80	17.75
14	9.00	14.80	11.75	24	16.50	22.30	19.25
16	10.50	16.30	13.25	26	18.00	23.80	20.75

5

5

NO.	PART NAME	MATERIAL	REMARK
1	HOUSING	PBT,94V-0	WHITE

A

B

C

D

E

SCALE: 1:1 UNIT: mm
SIZE: A4Unless otherwise
General Tolerance:
X ±0.40
X.x ±0.30
X.xx ±0.20
X° ±5°
X.x° ±3°

Title: Housing 1.50mm Pitch MX Dual Rows Male

Molde Code: GT-A1515HM-2XXX01

DRAWN	CHECKED	APPROVED	DATE
Hu	Hu	Chen	2021.10.20

品赞科技®
b-Switch
www.dg-switch.com

REV: A0

SHEET: 2/2