

SECTION:A-A

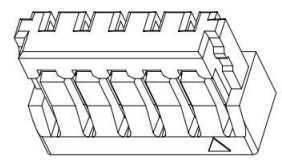

- G-Switch Specification:**
- 1.Current rated: 0.5A AC/DC
  - 2.Voltage rating: 30V AC/DC
  - 3.Withstanding voltage: 200V AC
  - 4.Contact resistance: 30mΩ max.
  - 5.Insulation resistance: 100MΩ min
  - 6.Durability cycle: 30Cycles
  - 7.Removal force: 0.50kgf/Pin min
  - 8.Operating temperature range: -40°C ~ +105°C

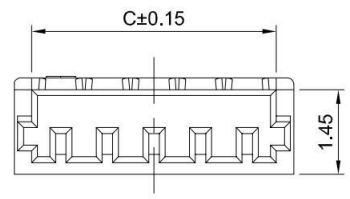
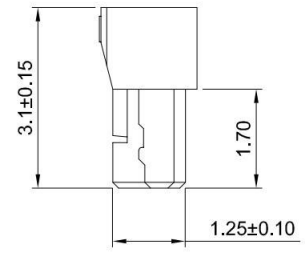
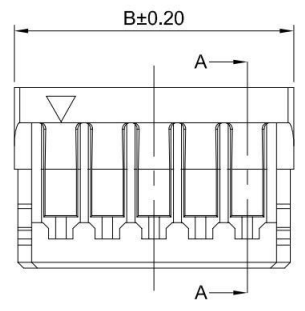

GT-D0801 H M 1 -1 XX X 0X

**G-Switch**  
**Series No**  
**Connector**  
 H-Housing  
**M-Male**  
**Type**  
 1-Type 1

**Material**  
 01-PA46  
 02-LCP

**Housing Colour**  
 S-Nature

**Pin Q' PY**  
 02-20

**Row NO**  
 1-Single Row

**Ordering Information:**

Circuit	Dimensions(mm)			Circuit	Dimensions(mm)		
	A	B	C		A	B	C
02	--	2.80	1.80	12	8.80	10.40	9.80
03	1.60	3.20	2.60	13	9.60	11.20	10.60
04	2.40	4.00	3.40	14	10.40	12.00	11.40
05	3.20	4.80	4.20	15	11.20	12.80	12.20
06	4.00	5.60	5.00	16	12.00	13.60	13.00
07	4.80	6.40	5.80	17	12.80	14.40	13.80
08	5.60	7.20	6.60	18	13.60	15.20	14.60
09	6.40	8.00	7.40	19	14.40	16.00	15.40
10	7.20	8.80	8.20	20	15.20	16.80	16.20
11	8.00	9.60	9.00	--	--	---	--

1	HOUSING	PA46,94V-0/LCP,94V-0	NATURE
NO.	PART NAME	MATERIAL	REMARK



SCALE: 1:1 UNIT: mm  
 SIZE: A4

Unless otherwise General Tolerance:  
 X ±0.40  
 X.x ±0.30  
 X.xx ±0.20  
 X° ±5°  
 X.x° ±3°

Title: Housing 0.80mm Pitch SUR Single Row Male

Molde Code: GT-D0801HM1-1XXX0X

DRAWN	CHECKED	APPROVED	DATE
Hu	Hu	Chen	2021.10.20



REV: A0 SHEET: 1/1