

A

B

C

D

E

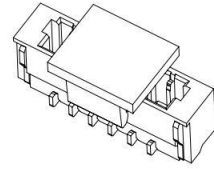
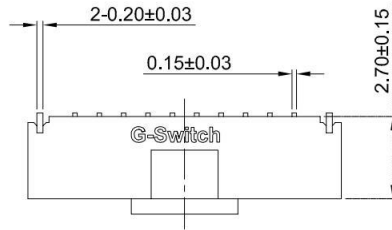
**G-Switch Specification:**

1. Current rated: 0.5A AC/DC
2. Voltage rating: 30V AC/DC
3. Withstanding voltage: 200V AC
4. Contact resistance: 30mΩ max.
5. Insulation resistance: 100MΩ min
6. Durability cycle: 30Cycles
7. Removal force: 0.50kgf/Pin min
8. Operating temperature range: -40°C ~ +105°C

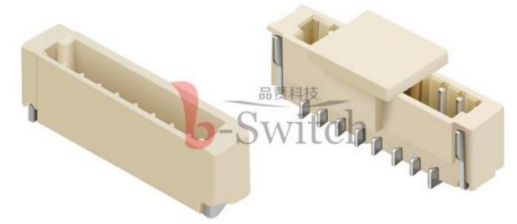

1

1

2

2

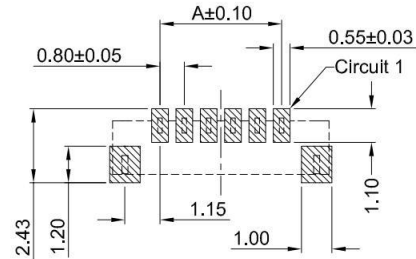
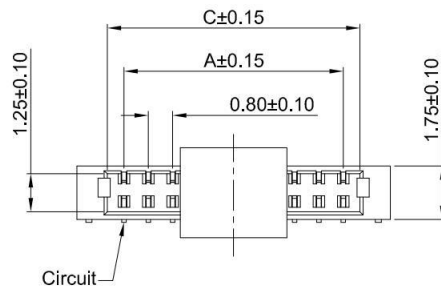

RECOMMENDED PCB LAYOUT  
TOLERANCE:±0.05

GT-D0801 W V S -1 XX X XX 01

G-Switch

Series No

Connector  
W-WaferAngle  
V-180°Termipoint  
S-SMTTerminal Plating  
BT-Bright Tin  
11-All G/FHousing Colour  
S-NaturePin Q' PY  
02-18Row NO  
1-Single row

3

3

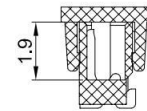
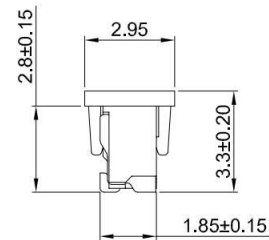
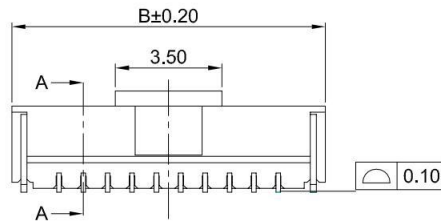

SECTION:A-A

**Ordering Information:**

Circuit	Dimensions(mm)			Circuit	Dimensions(mm)		
	A	B	C		A	B	C
02	---	3.90	1.90	11	8.00	11.10	9.10
03	1.60	4.70	2.70	12	8.80	11.90	9.90
04	2.40	5.50	3.50	13	9.60	12.70	10.70
05	3.20	6.30	4.30	14	10.40	13.50	11.50
06	4.00	7.10	5.10	15	11.20	14.30	12.30
07	4.80	7.90	5.90	16	12.00	15.10	13.10
08	5.60	8.70	6.70	17	12.80	15.90	13.90
09	6.40	9.50	7.50	18	13.60	16.70	14.70
10	7.20	10.30	8.30	---	---	---	---

4

4

4	SOLDER TABS	PHOSPHOR BRONZE	BRIGHT Tin / All G/F
3	CONTACT	PHOSPHOR BRONZE	BRIGHT Tin / All G/F
2	CAP	LCP,94V-0	NATURE
1	HOUSING	LCP,94V-0	NATURE
NO.	PART NAME	MATERIAL	REMARK

A

B

C

D

E

SCALE: 1:1

UNIT: mm

SIZE: A4



Title: Wafer 0.80mm Pitch 180° SUR SMT  
Type Connector

Unless otherwise  
General Tolerance:

X ±0.40  
X.x ±0.30  
X.xx ±0.20  
X° ±5°  
X.x° ±3°

Molde Code: GT-D0801WVS-1XXXXX01

DRAWN	CHECKED	APPROVED	DATE
Hu	Hu	Chen	2021.10.20

品赞科技®  
**b-Switch**  
www.dg-switch.com

REV: A0

SHEET: 1/1

5

5

