

RECOMMENDED PCB LAYOUT  
TOLERANCE:±0.05

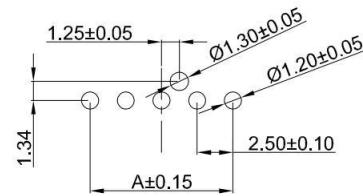

03/05/07Pin  
RECOMMENDED PCB LAYOUT  
TOLERANCE:±0.05

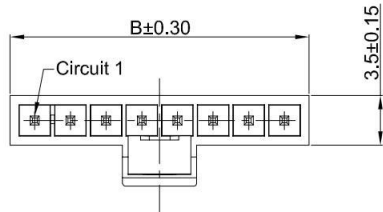
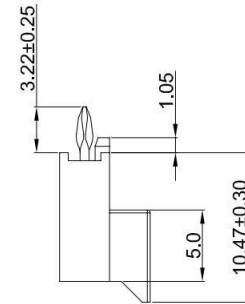
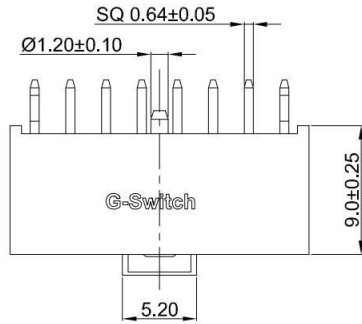
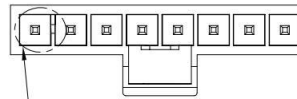

COLOR: BLACK

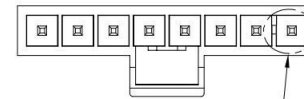

COLOR: NATURE

**G-Switch Specification:**

- 1.Current rated: 5.0-6.5A AC/DC
- 2.Voltage rating: 250V AC/DC
- 3.Withstanding voltage: 1500V AC
- 4.Contact resistance: 20mΩ max.
- 5.Insulation resistance: 1000MΩ min
- 6.Durability cycle: 25Cycles
- 7.Removal force: 3.5kgf/Pin min
- 8.Operating temperature range: -40°C ~ +105°C



GT-A2513 W V D-1 XX X XX 01

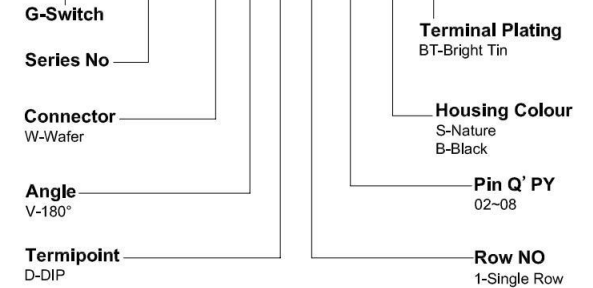

**Ordering Information:**

Circuit	Dimensions(mm)		Circuit	Dimensions(mm)	
	A	B		A	B
02	---	5.94	06	12.50	15.94
03	5.00	8.44	07	15.00	18.44
04	7.50	10.94	08	17.50	20.94
05	10.00	13.44	---	---	---

SCALE: 1:1 UNIT: mm  
SIZE: A4

Unless otherwise  
General Tolerance:  
X ±0.40  
X.x ±0.30  
X.xx ±0.20  
X\* ±5°  
X.X° ±3°

Title: Wafer 2.50mm Pitch MX 180° DIP  
With Lock Type Single Row Connector

Molde Code: GT-A2513WVD-1XXXXX01

DRAWN	CHECKED	APPROVED	DATE
Hu	Hu	Chen	2021.10.20



REV: A0 SHEET: 1/2

2	PIN MATERIAL	High Conductivity Copper Alloy	BRIGHT Tin
1	HOUSING	LCP,94V-0	BLACK/NATURE
NO.	PART NAME	MATERIAL	REMARK



A

B

C

D

E

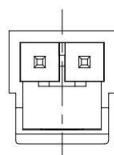

02Pin

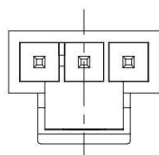

03Pin

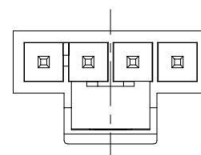

04Pin

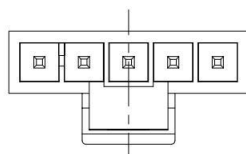

05Pin

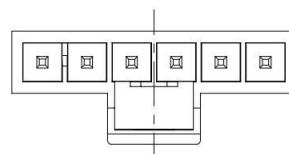

06Pin

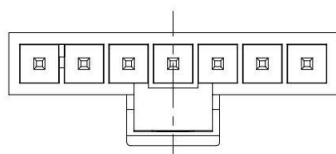

07Pin

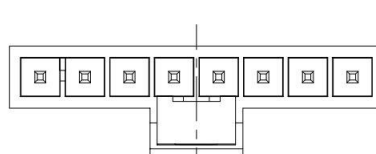

08Pin

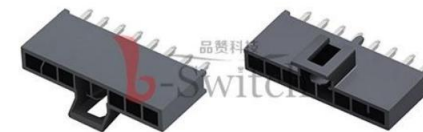

GT-A2513 W V D-1 XX X XX 01

G-Switch

Series No

Connector

W-Wafer

Angle

V-180°

Termipoint

D-DIP

Terminal Plating  
BT-Bright TinHousing Colour  
S-Nature  
B-BlackPin Q' PY  
02-08Row NO  
1-Single Row**G-Switch Specification:**

- 1.Current rated: 5.0-6.5A AC/DC
- 2.Voltage rating: 250V AC/DC
- 3.Withstanding voltage: 1500V AC
- 4.Contact resistance: 20mΩ max.
- 5.Insulation resistance: 1000MΩ min
- 6.Durability cycle: 25Cycles
- 7.Removal force: 3.5kgf/Pin min
- 8.Operating temperature range: -40°C ~ +105°C

**Ordering Information:**

Circuit	Dimensions(mm)		Circuit	Dimensions(mm)	
	A	B		A	B
02	---	5.94	06	12.50	15.94
03	5.00	8.44	07	15.00	18.44
04	7.50	10.94	08	17.50	20.94
05	10.00	13.44	---	---	---

SCALE: 1:1 UNIT: mm

SIZE: A4

Unless otherwise  
General Tolerance:

X ±0.40  
X.x ±0.30  
X.xx ±0.20  
X\* ±5°  
X.x° ±3°

Title: Wafer 2.50mm Pitch MX 180° DIP  
With Lock Type Single Row Connector

Molde Code: GT-A2513WVD-1XXXXX01

DRAWN	CHECKED	APPROVED	DATE
Hu	Hu	Chen	2021.10.20

品赞科技®  
www.dg-switch.com

REV: A0

SHEET: 2/2

2	PIN MATERIAL	High Conductivity Copper Alloy	BRIGHT Tin
1	HOUSING	LCP,94V-0	BLACK/NATURE
NO.	PART NAME	MATERIAL	REMARK



A

B

C

D

E