

SECTION:A-A

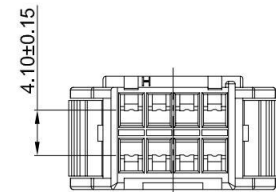
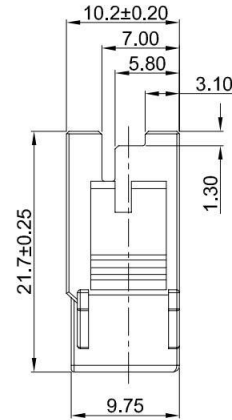
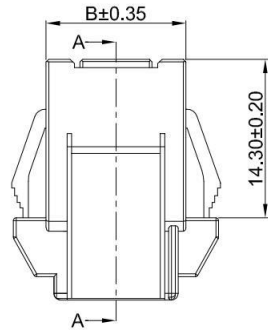

GT-A2508 H F -2 XX X 01

G-Switch

Series No

Connector
H-Housing

F-Female

Housing Colour
W-WHITE

Pin Q' PY
08~40

Row NO
2-Dual Rows

G-Switch Specification:

- 1.Current rated: 3.0A AC/DC
- 2.Voltage rating: 250V AC/DC
- 3.Withstanding voltage: 1000V AC
- 4.Contact resistance: 10mΩ max.
- 5.Insulation resistance: 1000MΩ min
- 6.Durability cycle: 50Cycles
- 7.Removal force: 2.0kgf/Pin min
- 8.Operating temperature range: -25°C ~ +85°C

Ordering Information:

Circuit	Dimensions(mm)		Circuit	Dimensions(mm)	
	A	B		A	B
08	7.50	12.70	24	27.50	32.70
10	10.00	15.20	26	30.00	35.20
12	12.50	17.70	28	32.50	37.70
14	15.00	20.20	30	35.00	40.20
16	17.50	22.70	32	37.50	42.70
18	20.00	25.20	34	40.00	45.20
20	22.50	27.70	36	42.50	47.70
22	25.00	30.20	40	47.50	52.70

SCALE: 1:1 UNIT: mm
SIZE: A4

Title: Housing 2.50mm Pitch XAD Dual Rows
With Lock Female

Unless otherwise
General Tolerance:
X ±0.40
X.x ±0.30
X.xx ±0.20
X° ±5°
X.x° ±3°

Molde Code: GT-A2508HF-2XXX01

DRAWN	CHECKED	APPROVED	DATE
Hu	Hu	Chen	2021.10.20



REV: A0 SHEET: 1/1

NO.	PART NAME	MATERIAL	REMARK
1	HOUSING	PA66,94V-0	WHITE

