

GT-A2508 H M -1 XX X 01

G-Switch

Series No

Connector
H-Housing

M-Male

Housing Colour
W-White

Pin Q' PY
02~15

Row NO
1-Single Row

G-Switch Specification:

- 1.Current rated: 3.0A AC/DC
- 2.Voltage rating: 250V AC/DC
- 3.Withstanding voltage: 1000V AC
- 4.Contact resistance: 10mΩ max.
- 5.Insulation resistance: 1000MΩ min
- 6.Durability cycle: 50Cycles
- 7.Removal force: 2.0kgf/Pin min
- 8.Operating temperature range: -25°C ~ +85°C

Ordering Information:

Circuit	Dimensions(mm)			Circuit	Dimensions(mm)		
	A	B	C		A	B	C
02	2.50	7.30	5.70	09	20.00	24.80	23.20
03	5.00	9.80	8.20	10	22.50	27.30	25.70
04	7.50	12.30	10.70	11	25.00	29.80	28.20
05	10.00	14.80	13.20	12	27.50	32.30	30.70
06	12.50	17.30	15.70	13	30.00	34.80	33.20
07	15.00	19.80	18.20	14	32.50	37.30	35.70
08	17.50	22.30	20.70	15	35.00	39.80	38.20

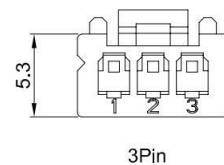
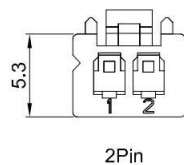
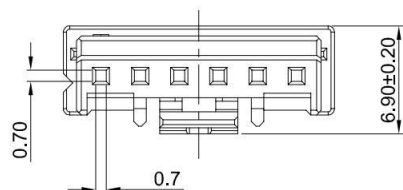
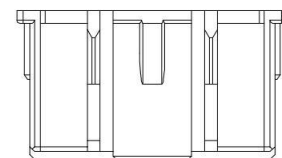
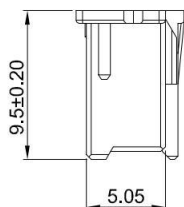
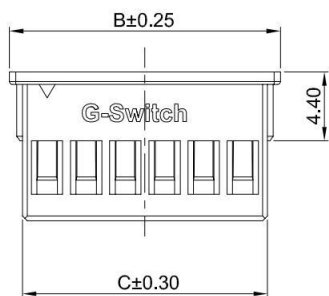

SCALE: 1:1 UNIT: mm
SIZE: A4

Unless otherwise
General Tolerance:
X ±0.40
X.x ±0.30
X.xx ±0.20
X° ±5°
X.x° ±3°

Title: Housing 2.50mm Pitch XA Single Row Male

Molde Code: GT-A2508HM-1XXX01

DRAWN	CHECKED	APPROVED	DATE
Hu	Hu	Chen	2021.10.20



REV: A0 SHEET: 1/1

1	HOUSING	PA66,94V-0	WHITE
NO.	PART NAME	MATERIAL	REMARK

