

GT-C2001 T F -X XX 1

**G-Switch**  
**Series No**  
**Connector**  
**Terminal Plating**  
 BT-Bright Tin  
 11-All G/F  
**Metal**  
 P-Phosphor Bronze  
**F-Female**  
**T-Terminal**

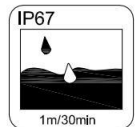
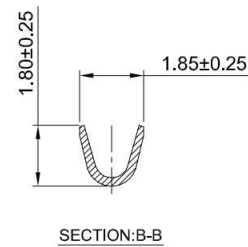
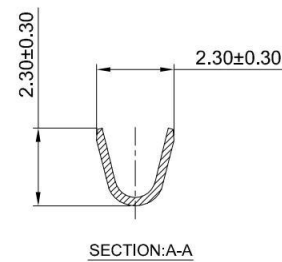
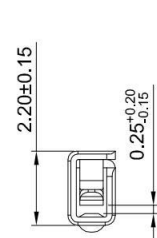

**G-Switch Specification:**

- 1.Current rated: 3.0A AC/DC
- 2.Voltage rating: 100V AC/DC
- 3.Withstanding voltage:1000V AC
- 4.Contact resistance: 10mΩ max.
- 5.Insulation resistance: 1000MΩ min
- 6.Durability cycle: 50Cycles
- 7.Removal force: 1.0kgf/Pin min
- 8.Operating temperature range: -40°C ~ +105°C

GT-C2001TF-P111	Phosphor bronze	All G/F	AWG#22~#26	1.60mm(Max)	9000
GT-C2001TF-PBT1	Phosphor bronze	Bright Tin	AWG#22~#26	1.60mm(Max)	9000
Part NO	Material	Plating	Wire Size	Insulation O.D	Reel/PCS



SCALE: 1:1 UNIT: mm  
 SIZE: A4

Unless otherwise General Tolerance:  
 X ±0.40  
 X.x ±0.30  
 X.xx ±0.20  
 X° ±5°  
 X.x° ±3°

Title: Terminal 2.00mm Pitch JWPF Crimp Style Female

Molde Code: GT-C2001TF-XXX1

DRAWN	CHECKED	APPROVED	DATE
Hu	Chen	Chen	2021.10.20



REV: A0 SHEET: 1/1