

A

B

C

D

E

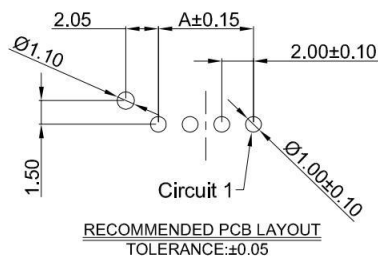
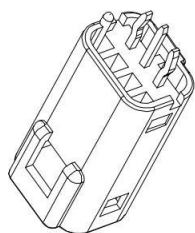
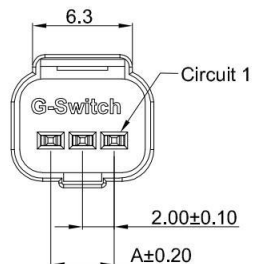

GT-C2001 W V D-1 XX X XX 01

G-Switch
Series No
Connector
W-Wafer
Angle
V-180°
Termipoint
D-DIP

Terminal Plating
BT-Bright Tin
Housing Colour
W-WHITE
Pin Q' PY
02-04
Row NO
1-Single Row

G-Switch Specification:

- 1.Current rated: 3.0A AC/DC
- 2.Voltage rating: 100V AC/DC
- 3.Withstanding voltage:1000V AC
- 4.Contact resistance: 10mΩ max.
- 5.Insulation resistance: 1000MΩ min
- 6.Durability cycle: 50Cycles
- 7.Removal force: 1.0kgf/Pin min
- 8.Operating temperature range: -40°C ~ +105°C

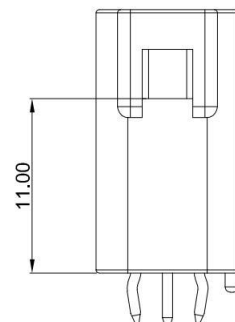
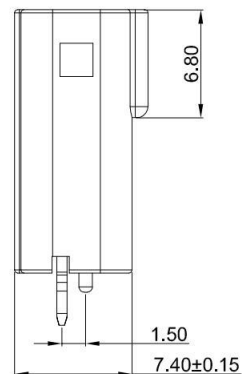
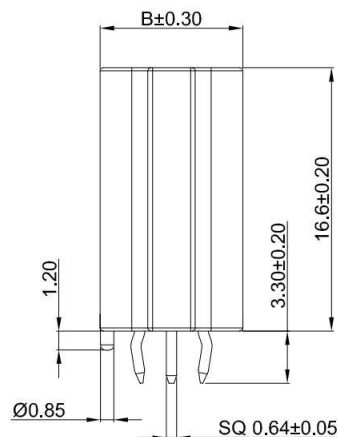

Ordering Information:

Circuit	Dimensions(mm)		Circuit	Dimensions(mm)	
	A	B		A	B
02	---	7.00	04	6.00	11.00
03	4.00	9.00	---	---	---

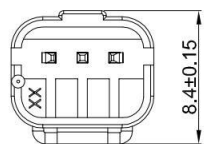

3Pin

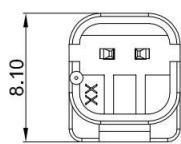

2Pin

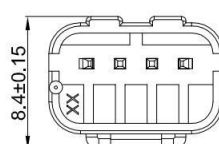

4Pin

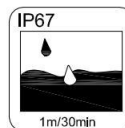

SCALE: 1:1 UNIT: mm
 SIZE: A4

Unless otherwise
 General Tolerance:
 X ±0.40
 X.x ±0.30
 X.xx ±0.20
 X° ±5°
 X.x° ±3°

Title: Wafer 2.00mm Pitch 180° DIP With Lock
 Type Single Row Connector

Molde Code: GT-C2001WVD-1XXXXX01

DRAWN	CHECKED	APPROVED	DATE
Hu	Hu	Chen	2022.12.28



REV: A0 SHEET: 1/1

2	PIN MATERIAL	BRASS	BRIGHT Tin
1	HOUSING	PBT,94V-0	WHITE
NO.	PART NAME	MATERIAL	REMARK



A

B

C

D

E