

A

B

C

D

E

G-Switch Specification:

- 1.Current rated: 3.0A AC/DC
- 2.Voltage rating: 250V AC/DC
- 3.Withstanding voltage: 1000V AC
- 4.Contact resistance: 10mΩ max.
- 5.Insulation resistance: 1000MΩ min
- 6.Durability cycle: 50Cycles
- 7.Removal force: 2.0kgf/Pin min
- 8.Operating temperature range: -25°C ~ +85°C

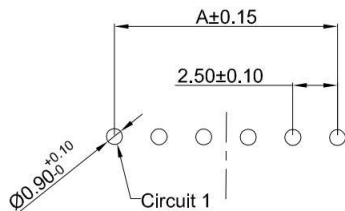
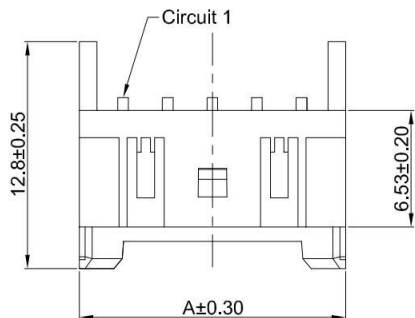

RECOMMENDED PCB LAYOUT
TOLERANCE:±0.05

GT-A2508 W R D-1 XX X XX 01

G-Switch

Series No

Connector
W-Wafer

Angle
R-90°

Termipoint
D-DIP

Terminal Plating
BT-Bright Tin

Housing Colour
S-Nature

Pin Q' PY
02~16

Row NO
1-Single Row

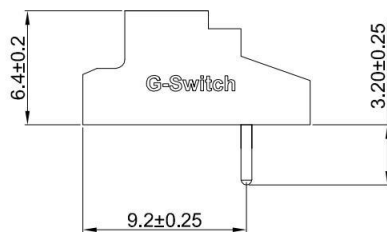
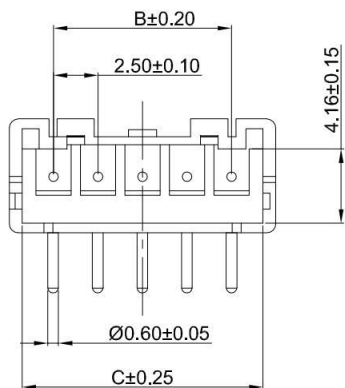

Ordering Information:

Circuit	Dimensions(mm)			Circuit	Dimensions(mm)		
	A	B	C		A	B	C
02	7.50	—	6.00	10	27.50	22.50	26.00
03	10.00	5.00	8.50	11	30.00	25.00	28.50
04	12.50	7.50	11.00	12	32.50	27.50	31.00
05	15.00	10.00	13.50	13	35.00	30.00	33.50
06	17.50	12.50	16.00	14	37.50	32.50	36.00
07	20.00	15.00	18.50	15	40.00	35.00	38.50
08	22.50	17.50	21.00	16	42.50	37.50	41.00
09	25.00	20.00	23.50	---	---	---	---

2	PIN MATERIAL	BRASS	BRIGHT Tin
1	HOUSING	PA66,94V-0	NATURE
NO.	PART NAME	MATERIAL	REMARK



SCALE: 1:1 UNIT: mm
SIZE: A4

Unless otherwise
General Tolerance:
X ±0.40
X.x ±0.30
X.xx ±0.20
X* ±5°
X.x° ±3°

Title: Wafer 2.50mm Pitch XA 90° DIP
With Lock Type Single Row Connector

Molde Code: GT-A2508WRD-1XXXXX01

DRAWN	CHECKED	APPROVED	DATE
Hu	Hu	Chen	2021.10.20



REV: A0 SHEET: 1/1

A

B

C

D

E