

G-Switch Specification:

- 1.Current rated: 1.0A AC/DC
- 2.Voltage rating: 125V AC/DC
- 3.Withstanding voltage: 500V AC
- 4.Contact resistance: 20mΩ max.
- 5.Insulation resistance: 100MΩ min
- 6.Durability cycle: 25Cycles
- 7.Removal force: 0.80kgf/Pin min
- 8.Operating temperature range: -25°C ~ +85°C



GT-A1254 W R S-1 XX X XX 0X

G-Switch

Series No

Connector
W-Wafer

Angle
R-90°

Termpoint
S-SMT

Type
01-LCP RoHS+HF
02-PA10T RoHS

Terminal Plating
11-AII G/F

Housing Colour
S-Nature

Pin Q' PY
02-20

Row NO
1-Single Row

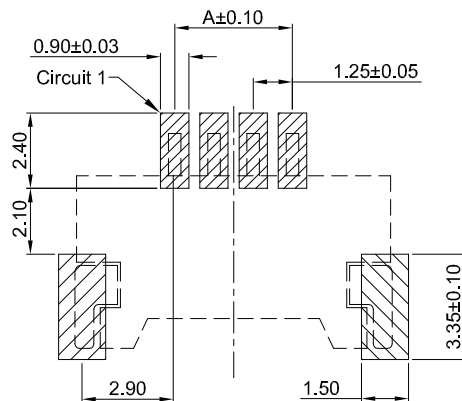
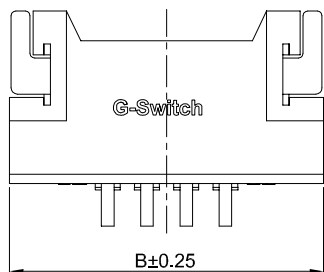
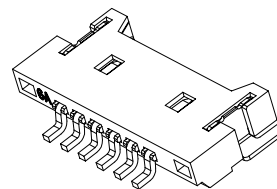
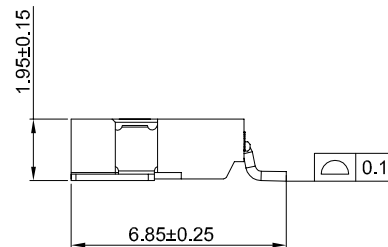
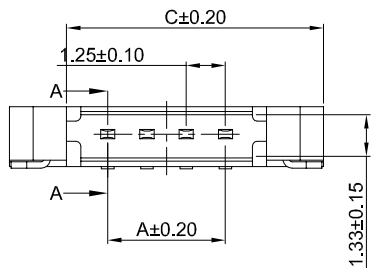

PCB REFERENCE DIAGRAM
TOLERANCE:±0.05

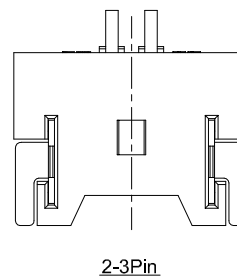

Ordering Information:

Circuit	Dimensions(mm)				Circuit	Dimensions(mm)			
	A	B	C	D		A	B	C	D
02	--	7.40	3.87	--	12	13.75	19.90	16.37	12.50
03	2.50	8.65	5.12	--	13	15.00	21.15	17.62	13.75
04	3.75	9.90	6.37	2.50	14	16.25	22.40	18.87	15.00
05	5.00	11.15	7.62	3.75	15	17.50	23.65	20.12	16.25
06	6.25	12.40	8.87	5.00	16	18.75	24.90	21.37	17.50
07	7.50	13.65	10.12	6.25	17	20.00	26.15	22.62	18.75
08	8.75	14.90	11.37	7.50	18	21.25	27.40	23.87	20.00
09	10.00	16.15	12.62	8.75	19	22.50	28.65	25.12	21.25
10	11.25	17.40	13.87	10.00	20	23.75	29.90	26.37	22.50
11	12.50	18.65	15.12	11.25	--	--	--	--	--

NO.	PART NAME	MATERIAL	REMARK
3	SOLDER TABS	PHOSPHOR BRONZE	All G/F
2	CONTACT	PHOSPHOR BRONZE	All G/F
1	HOUSING	PA10T,94V-0/LCP,94V-0	NATURE



SCALE: 1:1 UNIT: mm
SIZE: A4

Unless otherwise
General Tolerance:
X ±0.40
X.x ±0.30
X.xx ±0.20
X° ±5°
X.x° ±3°

Title: Wafer 1.25mm Pitch 90° SMT Type
Single Row Connector

Molde Code: GT-A1254WRS-1XXXXX01

DRAWN	CHECKED	APPROVED	DATE
Hu	Chen	Chen	2022.12.28



REV: A0 SHEET: 1/1